

THE EFFECT OF BUILDING FAÇADE MODEL ON LIGHT DISTRIBUTION (CASE STUDY: MENARA PHINISI BUILDING OF UNM)

Nurul Jamala

Departement of Architecture, Faculty of Engineering, Hasanuddin University
Email: nuruljamala@yahoo.co.id

ABSTRACT

Global warming issues influence the temperature of the earth surface. It is an impact on energy consumption, especially in buildings. Utilization of daylight is one of the factors that need to be considered, in order to minimize energy consumption as a source of artificial lighting. This study analyzed the distribution of light on the Menara Phinisi building of Makassar State University. Quantitative research method that is to describe the data of simulation in Autodesk Ecotect program. The research objective was to determine the effect of the building facade model on the value of illumination inside the building. Results of the study concluded that the decrease percentage of the distribution of light on the building facade using and not using the facade is 3,16% or 236 lux. Distribution of light in horizontal and diagonal facade models differ in the amount of 2,5%. Design analysis of the building serves as a guide for analyzing the influence of the building facade model so that it can create energy efficient buildings.

Keywords: Level illuminance; building façade; daylight.

INTRODUCTION

The architectural energy-saving concept is optimizing the lighting system taking into account the integration between daylight (sun) and artificial (lamp). The use of energy as a source of illumination will be reduced when daylight is used optimally by considering the negative effects such as glare, brightness and thermal. Utilization of daylight effect on the building envelope (facade), building orientation and wall wide openings.

Menara Phinisi of Makassar State University is a building for Academic Services Center (GPPA) in the form of podium consisting of three floors and part of the head in the form of a menara consisting of 12 floors which is a metaphor of the boat phinisi screen. Shape of the facade on the building, implemented a system which is a Paraboloid Hiperbolic as a facade futuristic sophistication of the application of science and technology.

Figure 1 shows the 17-storey Menara Phinisi building of UNM by building models shaped vertical (right and left) and diagonal (front and rear). The style of building facade beautify the shape of the building, but it is necessary to analyze how the percentage decrease in the level of light that can be penetrated into the building so that the use of energy as a source of artificial lighting can be minimized. It needs a study of daylight in the Menara Phinisi of Makassar State University.

LITERATUR STUDY

Energy consumption in office buildings is relatively large, but the use of energy as a source of artificial lighting is relatively small. Maximizing the use of sunlight as a source of daylight will reduce energy consumption as a source of artificial lighting, but worth noting negative effects that they may cause among others: glare, brightness and themal. This would reduce the comfort and productivity of the user's work space. This description, need special attention in terms of designing energy efficient buildings.

In order to improve the understanding of energy conservation in buildings, the National Standardization Agency (BSN) developed Energy Conservation in Lighting System that is SNI 03-6197-2000. This standard establishes guidelines for the provision of lighting in buildings. This is to obtain a lighting system with optimal operation so that energy can be efficiently consumed without reducing, changing functions of the building. Energy use in buildings is as a source of lighting, air conditioning, and other equipment. According Sugijanto (1998) that the distribution of energy consumption in buildings is 50-70% for air conditioning, lighting 10-25% and to 2-10% for Elevator.

In designing lighting, illumination standard recommendation is a reference in designing lighting space and is one of the parameters for creating space visual comfort. Particularly in Indonesia standards

recommended by SNI 03-6575-2001 on procedures for the design of artificial lighting systems in buildings is referring to the National Electric Code (NEC), Illuminating Engineering Society (IES), the International Electrotechnical Commission (IEC) and the Australian Standard. The level of illumination on the recommendation of ISO 2001 based on the function space for example for office buildings namely the director, work space, computer room recommended amount of 350 lux, conference room of 300 lux, the drawing room of 750 lux, warehouse archives of 150 lux and space active archive 300 lux.

Shading devices modify the intensity and distribution of daylight entering the space. Lighting design scheme and placement of control zones maybe affected. Facade on the building envelope influence the distribution of light (Nurul, 2016). Japanese authors Nakamura et al. (1985) have classified into three groups sky condition i.e. overcast, clear and intermediate trying to define the luminance distribution of the intermediate sky. Governor Regulation No. 38 (2012) explained that the building envelope is a building element that surrounds the building. They are transparent or not transparent walls or the roof. Karlen & James (2006) state that the skylight from the roof operates as lighting lamps that emit light directly with the direction of light down the hole while the light from the side using vertical openings to take advantage of daylight.

METHODOLOGY

Quantitative research method was using Autodesk Ecotect Analysis program 2011. This program is used to determine the level of illuminance at the measuring point in the building. This study analyzes the building facade to the lluminance level of daylight into the building and comparing the value of illuminance when using and not using the building facade on the building of Menara Phinisi of Makassar State University.

Program Autodesk Ecotect Analysis simulate Menara Phinisi building of UNM by designing the bearing window material single glazed aluminum frame and grid management. Calculated daylight level on CIE overcast sky. Simulation Conducted in Makassar with Climate Log-lat -5.10 and 119.50 (+8.0) in May at 12 o'clock.

RESULTS AND DISCUSSION

Autodesk Ecotect Analysis calculated results showed the level of lluminance in the Menara Phinisi Building of Makassar State University. Window

placement on the building envelope on the left, right, front and rear really varied so that the daylight coming into the building are different. Menara Phinisi Building consists of 17 floors, but the placement , area and shape resemble the façade is on each floor, so the analysis is only done on the 9th floor. Figure 2 below shows the vast differences, position and orientation the window as building envelope. This shows that level illuminance on the measurement point is the different, because wide window as opening on building envelope is different.

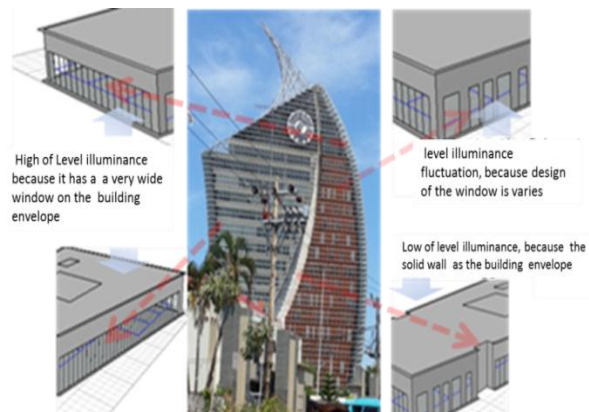

Fig 2. Design of window placement on the building envelope

Analysis Of Daylight Distribution in Buildings by Using and Not Using Facade.

Building facade design can beautify the appearance of the building. But to be kept in mind about the daylight distribution when using and not using the building facade. Electrical energy consumption can be reduced if it can maximize the use of daylight.

This study analyzes the light distribution when using and not using the hyperbolic paraboloid façade.

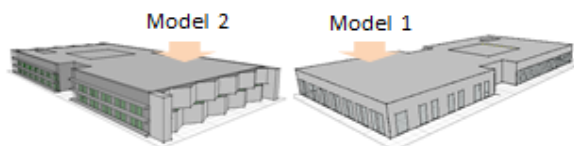

Fig. 3. Building Façade Design (Model 1 and 2)

Before the simulation of level illuminance in the building, conducted simulations of level illuminance in the outside area around the building envelope was conducted to determine the percentage distribution of daylight coming into the building, such as in Table 1 below.

Table 1. The Simulation Results Show the Level of Illumination in the area Outside of the Building

Position of Measure Point	Daylight Illuminance (lux)										Mean (lux)
The rear of the building	8043	7251	7341	7340	7381	7253	7155	7259	7270	7981	7427
The front of the building	8230	7636	7610	7608	7559	7602	7620	7890	7635	8163	7755
The right side of the building	7981	6879	6921	6964	6913	7292	6940	7340	7242	8163	7264
The left side of the building	8043	7227	7224	7103	7240	7457	7438	7427	7305	8230	7469

Table 2. Level of Illuminance in the Buiding without Building Façade (Model 1)

Position of measure point	Level of Illuminance / Model 1 (lux)										Mean (Lux)
The rear of building without facade)/ Zone A	1304	1043	1294	1051	696	1150	1094	1240	920	1256	1105
The front of building without facade)/ Zone B	670	1065	1088	1160	1082	978	1321	956	961	661	994
The right of building without facade)/ Zone C	1256	1245	1345	1451	1346	123	562	937	606	661	953
The left of building without facade)/ Zone D	1304	1522	1520	1460	1396	217	615	958	585	670	1025

Table 3. Level of Illuminance in the Building with Building Façade (Model 2)

Position of measure point	Level of Illuminance / Model 2 (lux)										Mean(lux)
The rear of building using facade)/Zone A	1055	689	1003	822	476	787	779	865	686	997	816
The front of building using facade)/ Zone B	542	742	778	789	752	704	923	682	671	518	710
The right of building using facade)/ Zone C	997	1031	1053	1161	1091	119	453	773	526	518	772
The left of building using facade)/Zone D	1055	1237	1196	1189	1179	203	511	769	449	542	833
Mean value of level illuminance (Lux)											783

Table 1 shows the daylight illuminance on the area of the building envelope. The average level of illuminance level outside the buildings is up to 7755 lux, and a minimum of 7264 lux. This value indicates that the level illuminance around the building are approximately equal in the amount of 7479 lux.

Then a simulation was performed to determine the value of illuminance inside the building. The measuring point was located at a distance of 1 meter from the building envelope, such as the table 2 and 3 below.

Table 2 shows level of illuminance in the building without building façade or model 1 and table 3 shows Level of illuminance in the building using hyperbolic paraboloid as building façade or model 2.

Based on the three tables above, it can be seen that the distribution of light into the building with values almost the same in all zone building envelope.

The distribution of light percentage on of the building without the facade (model 1) amounted to 13.63%, while use of the facade (model 2) amounted to 10.47%. Based on this description, it can be concluded that the distribution of light affect the building façade.

Figure 5 shows that the value of level of illuminance on the building using façade less than the not using façade. Differences in light distribution when using and not using the building facade is equal to 3.16% or 236.5 lux

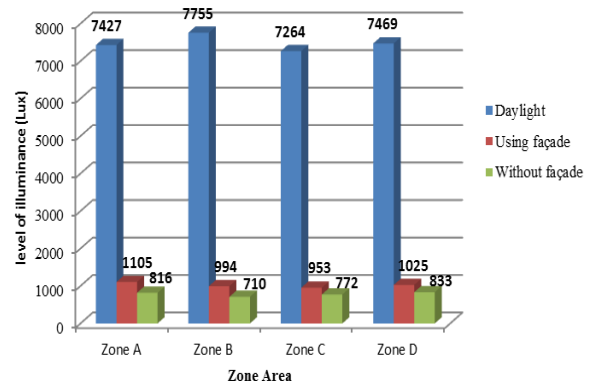

Fig. 4. The Light Distribution of Daylight

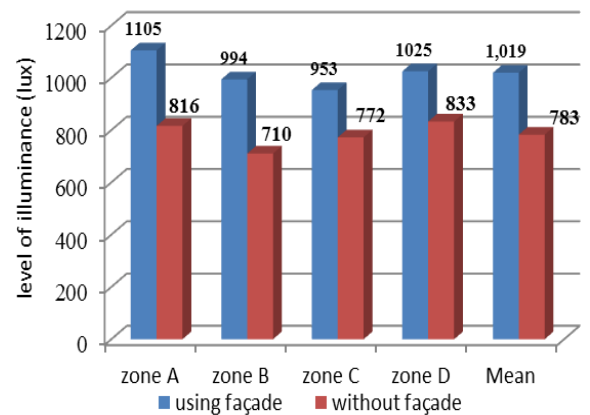

Fig. 5. Distribution of Light on the Building using and not using the Building Façade

Analysis of the Light Distribution of Model Facade

Furthermore, the model building facade will be analyzed. Facade model on Menara Phinisi building of UNM uses horizontal and diagonal. The rear of building using diagonal façade (Zone A), The front of building using diagonal façade (Zone B), The right side of building using horizontal façade (Zone C) and The left side of building using horizontal façade (Zone D). This study analyzes the differences in the distribution of light into the building, when using horizontal or diagonal façade.

The simulation results show the level illuminance in buildings by using diagonal facade (zone A and B) and horizontal façade (Zone C and D), such as Figure 7.

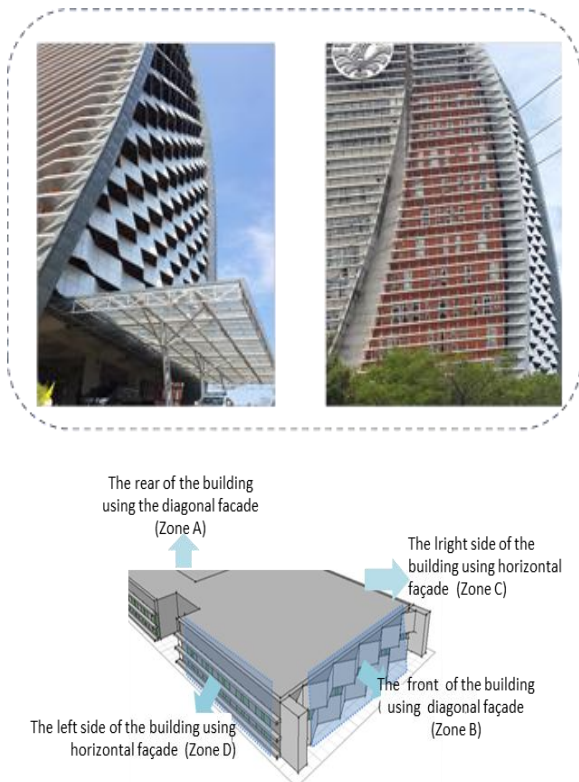

Fig.6. Facade Design of the rear, front, left and right side of the buiding

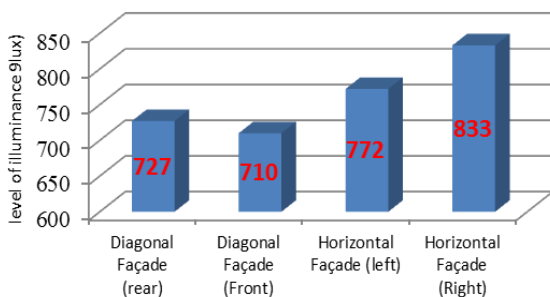

Fig. 7. The Simulation Result of Illuminance Level

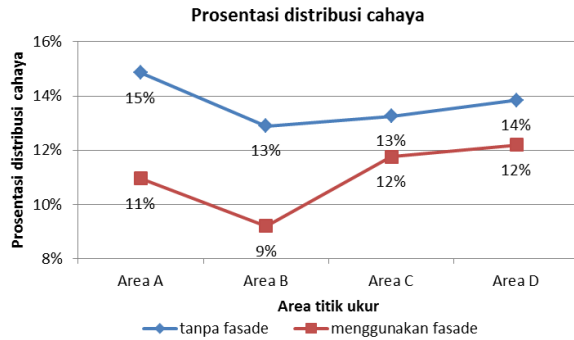

Fig. 8. The Percentage Distribution of Daylight

Figure 7 shows the distribution of light by using a model of horizontal and diagonal facade. The average level of illuminance on a diagonal facade area amounted to 727 lux and 710 lux while the diagonal facade of 772 lux and 833 lux. This suggests that the the building facade models effect on distribution of light that enters the building. The absorption of level of illuminance is higher when using horizontal facade.

Figure 8 shows that in the zone A and B decreased by 4%, ie 11-15% and zone B (13% -9%) so it can be concluded that the decrease percentage is 4% when using diagonal facade. Further, zones C and D decreased by 1-2%, ie zone C of 12% -13% and zone D by 14% -12%. Average value of the difference of level of illuminance value between the model façade diagonal and horizontal is 2.5%. Based on this description, it can be concluded that the building facade model influences the distribution of daylight.

CONCLUSION

The study concluded that the level of illuminance effect on the building facade. Result of research shows that this value indicates that the level of illuminance of daylight on around the building are approximately equal in the amount of 7479 lux.

Light distribution in the Menara Phinisi building of UNM, when not using the facade has average value of 1019 lux or 13,63%. Whereas when using hyperbolic paraboloid facade generates a mean value of 783 lux or 10,47%. Based on this, it can be concluded that a decline of 3,16% or 237 lux when using the facade, but can be avoided from negative effects such as glare, brightness and heat.

The study also concluded that the value of illumination effect on the building facade design forms. At UNM phinisi tower building, there is a difference of light distribution when not using and use the façade diagonal produces an average value of 4%,

while the shape of a horizontal façade produce a mean value of 1.5% percent. It can be concluded the differences of the decline of daylight distribution by using diagonal and horizontal form of 2.5%.

REFERENCES

- Pritchard, D. C. (1986). *Interior Lighting Design*, 6th ed., The Lighting Industry Federation Ltd. and The Electricity Council, London
- Badan Standardisasi Nasional (2001), *Tata Cara Sistem Perancangan Sistem Pencahayaan Alami Pada Bangunan Gedung*, SNI 03-2396-2001, Jakarta.
- Illuminating Engineering Society (1977). IES code for Interior Lighting, *IES Lighting Handbook*, London
- M. Wegmuller, J. P. von der Weid, P. Oberson, and N. Gisin, "High resolution fiber distributed measurements with coherent OFDR," in *Proc. ECOC'00*, 2000, **11**(3-4), pp. 109.
- Illuminating Engineering Society of North America (1993). *American national standard practice for office lighting*. New York: *Illuminating Engineering Society of North America*.
- Jamala, N. (2016). *The Effect of Building on Natural Lighting (Case Study: Building of Phinisi Tower UNM)*, 7th International Conference on Mechanical and Manufacturing Engineering "Sustainable Energy Toward Global Synergy, Univesiti Tun Hussein Onn Malaysia, Jogjakarta.
- Lembaga Pendidikan Masalah Bangunan (2001). *Tata Cara Perancangan Penerangan Alami Siang Hari Untuk Rumah dan Gedung*, SNI 03-6575-2001, Jakarta.
- Nakamura, H., Oki, M. & Hayashi, Y. (1985). Luminance Distribution of intermediate sky. *Journal of Light and Vis. Environment*, **9**(1), pp.n6-13
- Soegjanto (1993). *Standar Tata Cara Perancangan Konversi Energi*.